

Other



O t h e r



13.OTHER

13.1 Glass Vessel Couplers

BOMEX glass vessel series couplers are self-developed products, used for the connection of various glass vessels for evaporation, chemical reaction, reflux feeding and storage. These couplers, together with BOMEX special flange systems, provide convenience for the connection of glass apparatus with glass lined apparatus, featuring flexibility and easy installation.

Features:

- They are made of borosilicate glass 3.3 to ensure reliability and safety, eliminating the defects of PTFE couplers, which are costly and likely to deform.
- Glass reflux couplers are designed with long exit pipes, thus solving the problem of the formation of wall flow.
- The special flange systems are of standardized metal design with high-temperature resistant buffer material and special BTFE seals, equipped with temperature compensation spring devices to prevent leakage due to sharp temperature variation.

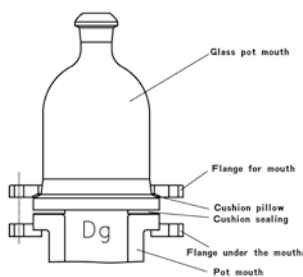

BOMEX reaction vessel couplers are suited for HG5-261-79, HG-263-79 system. Please specify clearly the system type and the product number when ordering. We also provide non-standard couplers according to the requirement of the customers.

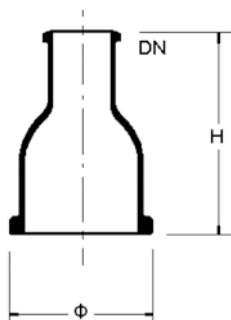
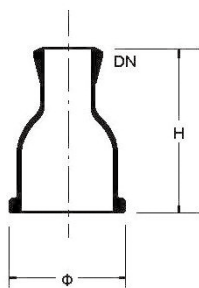

13.1.1 Glass Vessel Couplers

Φ mm	H mm	DN	Suitable joint Dg	Cat. No. (conical)	Cat. No. (spherical)
110	175	40	70	KGK-11-70/1.5"	QGK-11-70/40
		50		KGK-11-70/2"	QGK -11-70/50
		80		KGK-11-70/3"	QGK -11-70/80
120	175	40	80	KGK-11-80/1.5"	QGK -11-80/40
		50		KGK-11-80/2"	QGK -11-80/50
		80		KGK-11-80/3"	QGK -11-80/80
140	200	40	100	KGK-11-100/1.5"	QGK -11-100/40
		50		KGK-11-100/2"	QGK -11-100/50
		80		KGK-11-100/3"	QGK -11-100/80
		100		K GK-11-100/4"	QGK -11-100/100*
170	225	50	125	KGK-11-125/2"	QGK -11-125/50
		80		KGK-11-125/3"	QGK -11-125/80
		100		KGK-11-125/4"	QGK -11-125/100*

Φ mm	H mm	DN	Suitable joint Dg	Cat. No. (conical)	Cat. No. (spherical)
185	250	50	150	KGK-11-150/2"	QGK -11-150/50
		80		KGK-11-150/3"	QGK -11-150/80
		100		KGK-11-150/4"	QGK -11-150/100*
250	350	80	200	KGK-11-200/3"	QGK -11-200/80
		100		KGK-11-200/4"	QGK -11-200/100*
	375	150		KGK-11-200/6"	QGK -11-200/150*
		Φ180		KGK-11-200/7"	QGK -11-200/180*

*DN100/DN150/Φ180 are plane joints

13.1.2 Reflux Vessel Couplers

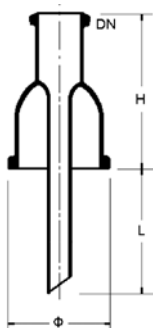
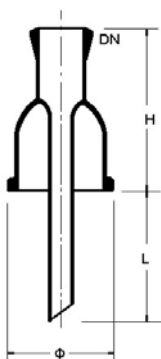

Φ mm	H mm	L mm	DN	Suitable joint Dg	Cat. No. (conical)	Cat. No. (spherical)
110	175	100	15	70	KGK-12-70/3/4"	QGK-12-70/15
	175	125	25		KGK-12-70/1"	QGK-12-70/25
	175	150	40		KGK-12-70/1.5"	QGK-12-70/40
	175	150	50		KGK-12-70/2"	QGK-12-70/50
120	175	125	25	80	KGK-12-80/1"	QGK-12-80/25
	175	150	40		KGK-12-80/1.5"	QGK-12-80/40
	175	150	50		KGK-12-80/2"	QGK-12-80/50
140	200	125	25	100	KGK-12-100/1"	QGK-12-100/25
	200	150	40		KGK-12-100/1.5"	QGK-12-100/40
	200	150	50		KGK-12-100/2"	QGK-12-100/50
170	225	125	25	125	KGK-12-125/1"	QGK-12-125/25
	225	150	40		KGK-12-125/1.5"	QGK-12-125/40
	225	150	50		KGK-12-125/2"	QGK-12-125/50
	225	175	80		KGK-12-125/3"	QGK-12-125/80
185	250	125	25	150	KGK-12-150/1"	QGK-12-150/25
	250	150	40		KGK-12-150/1.5"	QGK-12-150/40
	250	150	50		KGK-12-150/2"	QGK-12-150/50
	250	175	80		KGK-12-150/3"	QGK-12-150/80
250	325	125	25	200	KGK-12-200/1"	QGK-12-200/25
	350	150	40		KGK-12-200/1.5"	QGK-12-200/40
	350	150	50		KGK-12-200/2"	QGK-12-200/50
	375	175	80		KGK-12-200/3"	QGK-12-200/80

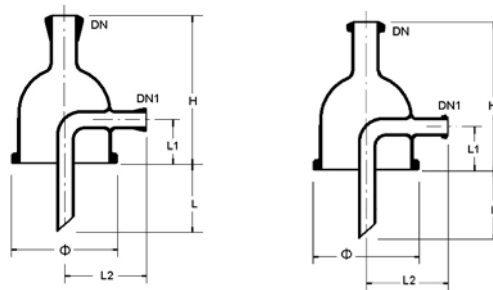

13.1.3 Distillation Reflux Vessel Coupler

Φ mm	H mm	L mm	L1 mm	L2 mm	DN	DN1	Suitable joint Dg	Cat. No. (conical)	Cat. No. (spherical)
110	200	100	100	110	40	15	70	KGK-13-70/1.5"/3/4"	QGK-13-70/40/15
	200	150		125	40	25		KGK-13-70/1.5"/1"	QGK-13-70/40/25
	200	150		125	50	25		KGK-13-70/2"/1"	QGK-13-70/50/25
	200	150		125	80	25		KGK-13-70/3"/1"	QGK -13-70/80/25
120	200	125	100	110	40	15	80	KGK-13-80/1.5"/3/4"	QGK -13-80/40/15
	200	125		125	40	25		KGK-13-80/1.5"/1"	QGK -13-80/40/25
	200	125		110	50	15		KGK-13-80/2"/3/4"	QGK -13-80/50/15
	200	125		125	50	25		KGK-13-80/2"/1"	QGK -13-80/50/25
	200	125		125	80	25		KGK-13-80/3"/1"	QGK -13-80/80/25
140	200	125	100	125	40	25	100	KGK-13-100/1.5"/1"	QGK -13-100/40/25
	200	125		125	50	25		KGK-13-100/2"/1"	QGK -13-100/50/25
	200	125		125	80	25		KGK-13-100/3"/1"	QGK -13-100/80/25
	200	150		125	80	40		KGK-13-100/3"/1.5"	QGK -13-100/80/40
	200	150		125	100	25		KGK-13-100/4"/1"	QGK -13-100/100*/25
	200	150		125	100	40		KGK-13-100/4"/1.5"	QGK -13-100/100*/40
170	250	150	120	125	50	25	125	KGK-13-125/2"/1"	QGK -13-125/50/25
	250	125		150	80	25		KGK-13-125/3"/1"	QGK -13-125/80/25
	250	150		150	80	40		KGK-13-125/3"/1.5"	QGK -13-125/80/40
	250	125		150	100	25		KGK-13-125/4"/1"	QGK -13-125/100*/25
	250	150		150	100	40		KGK-13-125/4"/1.5"	QGK -13-125/100*/40
185	275	125	120	150	80	25	150	KGK-13-150/3"/1"	QGK -13-150/80/25
	275	150		150	80	40		KGK-13-150/3"/1.5"	QGK -13-150/80/40
	250	125		150	100	25		KGK-13-150/4"/1"	QGK -13-150/100*/25
250	375	150	150	200	100	25	200	KGK-13-200/4"/1"	QGK -13-200/100*/25
				200	150	40		KGK-13-150/6"/1.5"	QGK -13-200/150*/40
				200	150	50		KGK-13-150/6"/2"	QGK -13-200/150*/50
				200	Φ180	40		KGK-13-150/7"/1.5"	QGK -13-200/180*/40
				200	Φ180	30		KGK-13-150/7"/2"	QGK -13-200/180*/50

* DN100/DN150/Φ180 are spherical joint.

13.1.4 Dripping Vessel couplers

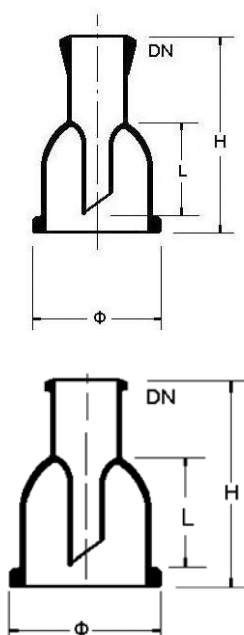

Φ mm	H mm	L mm	DN	Suitable joint Dg	Cat. No. (conical)	Cat. No. (spherical)
110	175	70	15	70	KGK-14-70/3/4"	QGK -14-70/15
	175	70	25		KGK-14-70/1"	QGK -14-70/25
	175	70	40		KGK-14-70/1.5"	QGK -14-70/40
120	175	70	25	80	KGK-14-80/1"	QGK -14-80/25
	175	70	40		KGK-14-80/1.5"	QGK -14-80/40
	175	70	50		KGK-14-80/2"	QGK -14-80/50
140	225	90	25	100	KGK-14-100/1"	QGK -14-100/25
	225	90	40		KGK-14-100/1.5"	QGK -14-100/40
	225	90	50		KGK-14-100/2"	QGK -14-100/50
170	250	100	25	125	KGK-14-125/1"	QGK-14-125/25
	250	100	40		KGK-14-125/1.5"	QGK-14-125/40
	250	100	50		KGK-14-125/2"	QGK-14-125/50
	250	100	80		KGK-14-125/3"	QGK-14-125/80

13.2 Connection

13.2.1 Flange Set (General type)

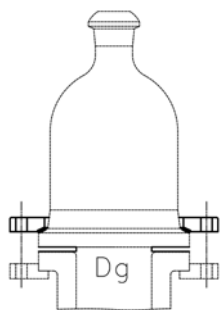

Suitable joint Dg	Cat. No.
70	BGK-CTFL-70
80	BGK-CTFL-80
100	BGK-CTFL-100
125	BGK-CTFL-125
150	BGK-CTFL-150
200	BGK-CTFL-200

Including 1 flange, 2 flat gaskets, 1 cushion and bolt and springs.

13.2.2 Flange (General type)

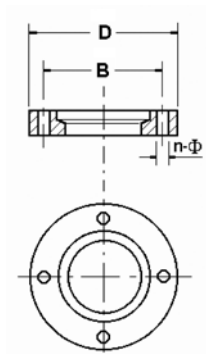

Suitable joint Dg	D mm	B mm	n-Φ	Cat. No.
70	160	130	4-Φ14	BGK-FL-70
80	185	150	4-Φ14	BGK-FL-80
100	205	170	4-Φ14	BGK-FL-100
125	235	200	8-Φ14	BGK-FL-125
150	260	225	8-Φ14	BGK-FL-150
200	315	280	8-Φ14	BGK-FL-200

13.2.3 Sealing

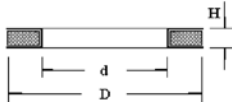

Suitable joint Dg	D mm	d mm	H mm	Cat. No.
70	110	68	2	BGK-MF-70
80	120	78	2	BGK-MF-80
100	140	83	2	BGK-MF-100
125	170	121	2	BGK-MF-125
150	185	139	2	BGK-MF-150
200	249	204	2	BGK-MF-200

13.2.4 Flange Bolts and Compensation Springs

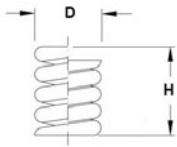

Suitable joint Dg	D mm	H mm	M*L mm	Cat. No.
70	27	40	M10*110	BGK-LSTH-70
80	27	40	M10*110	BGK-LSTH-80
100	27	40	M10*110	BGK-LSTH-100
125	27	40	M10*110	BGK-LSTH-125
150	27	40	M10*110	BGK-LSTH-150
200	27	40	M10*110	BGK-LSTH-200

13.3 Vision Tube



DN	S	h	Cat. No.
25	3.3	100	BGK-SZ-25
40	3.5	100	BGK-SZ-40
50	4	100	BGK-SZ-50
80	4.7	100	BGK-SZ-80
100	6	100	BGK-SZ-100

* Length is changeable according to customer's request.